

Creating Services

For more information about services and service types, see [Services and Other App Elements](#).

You create services in the App Builder (see [Working with the App Builder](#)). For static content services, you must continue to create the service in the Content menu ([Working with Static Content and the Content Menu](#)). For integration services, you must continue to create the service in the AEK Content menu ([Working with the Application Extension Kit](#)).

For more information, see [Add Tiles to Your App Homescreen](#), [How to Add a Tile to an App Profile](#), and [Creating Content Pages](#).

To create a new service:

1. Before creating the service:
 - Upload any files, images, or other contents required for the service. See [Uploading Files](#).
 - If you are creating a feed service, and you plan to use pre-configured feeds (see [Configuring Default RSS Feeds](#)), configure the feeds and ensure that the feeds are available to the relevant app roles. See also [Managing App Roles](#).
 - If you are creating a default banner service, configure the default banner images (see [Configuring Default Banner Images](#)) and ensure that the images are available to the relevant app roles. See also [Managing App Roles](#).
 - If you are creating an integration service, deploy the AEK screen using your AEK development environment (CLI) to the app. For more information, see [AEK \(Application Extension Kit\)](#).
2. In the App Builder, in the **Menu Options** tab, select **Add**. The Create New Menu Option pane appears.

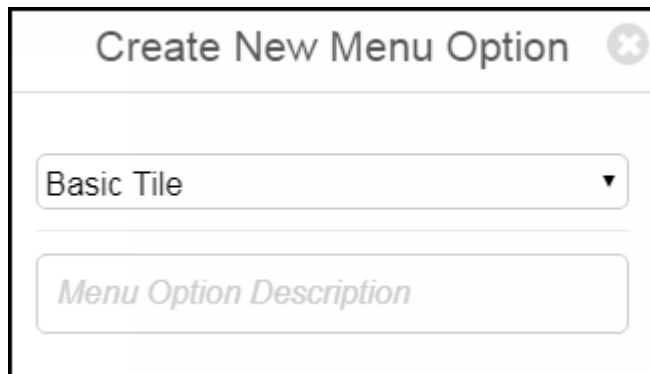

Create New Menu Option Pane

3. Select the service type:
 - **AEK Component** - An integration service. A service that provides other dynamic content, build using the Application Extension Kit (AEK). See [Working with the Application Extension Kit](#).
 - **Alerts Tile**
 - **Banners Tile** - A service that presents an image marquee.
 - **Basic Tile** - A basic service: a basic, non-functional tile, or one that, when selected, redirects to another service or URL.

- **Calendar Tile** - A live tile that shows the next timetable item and opens the calendar.
 - **Content Menu Option** - A static contents service.
 - **Feeds Tile** - A service that provides dynamic syndicated content from an RSS feed.
 - **Maps Tile**
 - **Product Features Tile**
 - **Product Integrations Tile**
 - **Smart Tile** - A live tile that shows the next activity in a timetable or feed, and opens the calendar or the event feed:
 - **Day View** - For React Native, a live tile that shows the next scheduled activity of the day, from any timetable or feed included in the calendar (see [Feature Focus – My Calendar](#))
 - **Events** - A live tile that shows the next scheduled event from a specific feed
 - **Nested Smart Tile** - A live tile with links to multiple feeds
 - **Tile Container** - A fully customizable container for tiles that allows better organization of homepage content. For more information, see [Configuring Tile Containers](#).
4. Enter a name (short description) for the service.
 5. Select **Create**. The service is created. By default, the service is enabled. The service tab appears, enabling you to configure the service. See [Configuring Services](#).

Note

The service is initially configured with any default system service properties, as well as any properties configured as default for the profile. See [Configuring Default Service Properties](#) and [Managing Profile Defaults for Services](#).

If you created a basic, feed, or banner service, after configuring and saving the service, you are done.

Otherwise, you must save the newly created service before continuing. You can configure the service before saving it or at a later time.

Note

To prevent end-users from seeing the service while you are still working on it, configure the app roles for the service to be only ones that are not used by end-users, or disable the service, before saving it.

- For a basic service, ensure that you configure the URL, if the service is intended to open another service when the end-user selects it.
 - For a feed service, ensure that you configure the feed sources (**Feeds**).
 - For a banner service, ensure that you configure the banner images (**Banners**).
 - For a static content or an integration service, continue with step 6 or 7, respectively.
6. For a static content service, open the Content menu (**App Settings > Content > Content**) and locate the service.
-

Note

See [Creative Studio](#) for an alternate method of creating and configuring static content services.

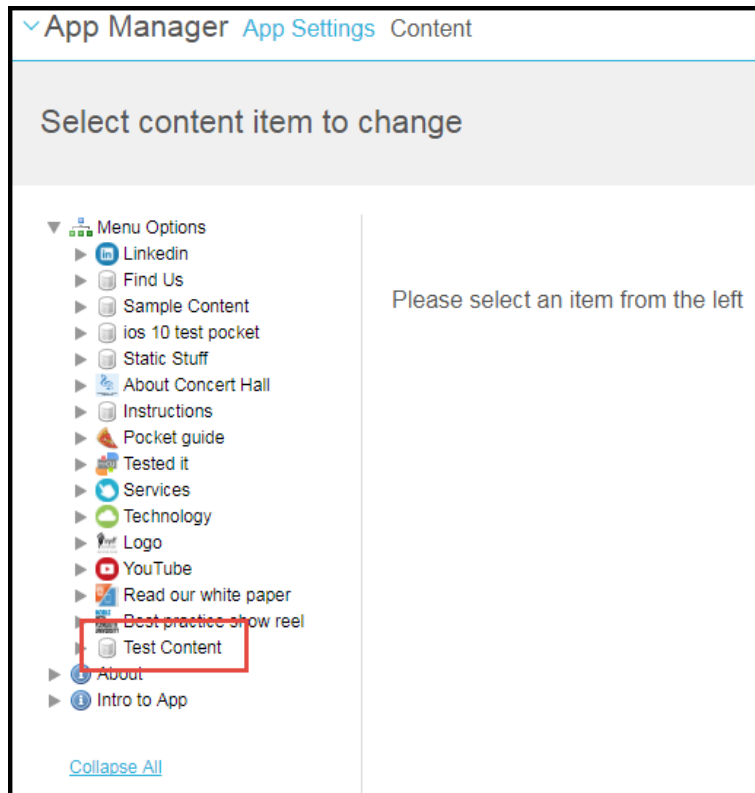

Content Menu

Add one or more sub-nodes to the service (see [Working with Static Content and the Content Menu](#)) with the required menu structure and/or content pages/redirects. Note that a static content service without any sub-nodes functions exactly like a basic service.

Don't forget to save your changes.

7. For an integration service:

1. Configure the AEK screen (after deploying the AEK screen using your AEK development environment (CLI)). You create and manage AEK screens on the the Select AEK screen to change page (**AEK > App Extension Kit > AEK Screens**). This page presents a list of AEK screen for use in your integration services; for information about working with lists, see [Working with Lists](#). The only field you may want to configure is **SSO protected**: if using SSO authentication (see [Configuring End-User Authentication Types](#)), select **Yes**. The other fields (**Ref**, **Description**, **GPS Enabled**, and **Precache**) are not in use.
2. Open the Select AEK menu option to change page (**AEK > App Extension Kit > AEK Menu Options**). This page presents a list of integration services; for information about working with lists, see [Working with Lists](#). Edit the service and configure:
 - Description - The name of the service. This is the same as the **Description** field that you can configure while configuring the service; see [Configuring How Services Appear](#).
 - Image Icon - Tile background image. This is the same as the **Image** field that you can configure while configuring the service; see [Configuring How Services Appear](#).
 - Authentication Access - The authentication access. These options (appearing on **App Settings > Customer Web Services > Authentication Access**) are configured together with Ex Libris during setup.
 - Profile owner - Optionally select a profile. When selected, the integration service will only appear in this profile.
 - Roles - Optionally select the roles for which this service appears.

- Toolbar items - The integration service screen. Note: although multiple screens are supported in the UI, the current version of campusM only supports a single screen. Add one screen and don't add any others. The only field required when adding a screens is **Screen**: select the screen configured in the previous step. If installing the app on a public kiosk and using LDAP authentication for the service, set **Secure Prompt** to **Yes** so that the service will prompt for a login every time it is launched. The other fields (**Label**, **Description**, and **Icon image**) are not in use.
8. Continue with configuring the service in the App Builder; see [Configuring Services](#). Ensure the service is enabled for all required roles; see [Enabling/Disabling Services in Apps](#).