

---

## Registration Status

---

### Overview

The Registration Status product integration allows students to view their registration status for a particular term.

---

### Vendors

The Registration Status product integration is currently supported by the Ellucian Banner (XE) and Oracle PeopleSoft vendors.

---

### User Experience

The following section describes information relating to the user experience for the Registration Status product integration.

---

#### User Activities

Students can view their registration status for a particular term.

---

#### User Workflow

A single page application (SPA) with no redirects out of the page (or app).

---

#### Authentication

The Registration Status product integration requires the user's identifier from the vendor's system. This is obtained with the token based authentication attributes.

The connection to the vendor is handled as part of the generic API Configuration component (in App Manager, in the product instance). This is found under the Vendor section on the configuration page.

---

#### Offline Support

No offline support is provided, since the data would not be current and no data is preferable to inaccurate data.

---

#### Screenshots

The following are examples of screenshots of the Registration Status product integration user interface for a reference when configuring it:

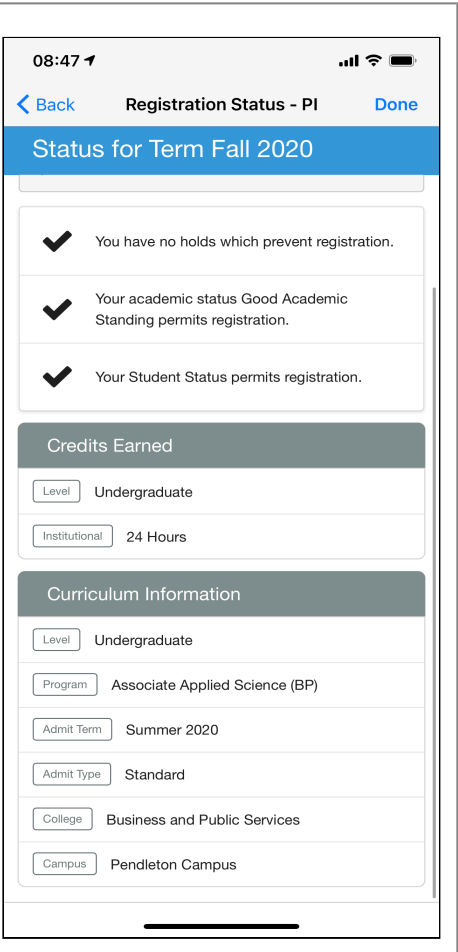
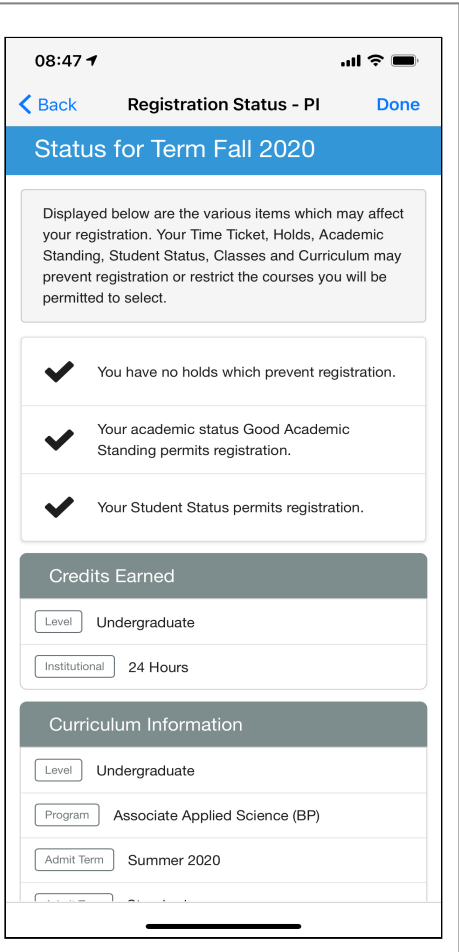
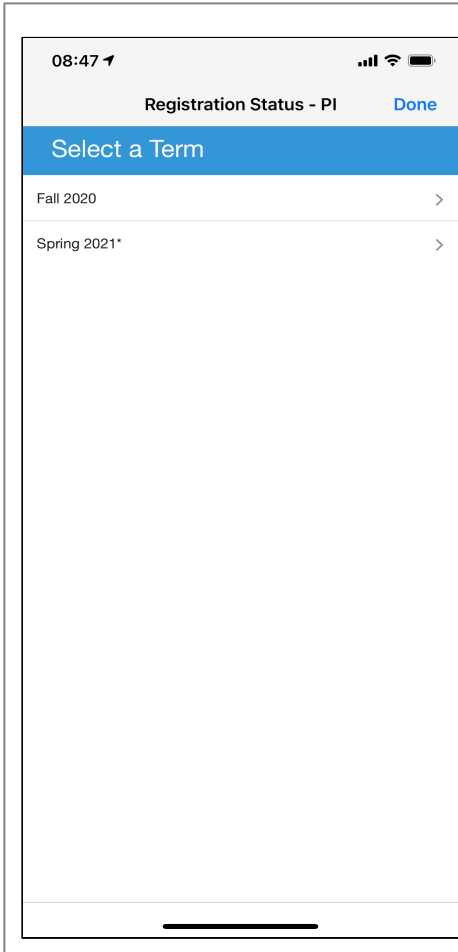

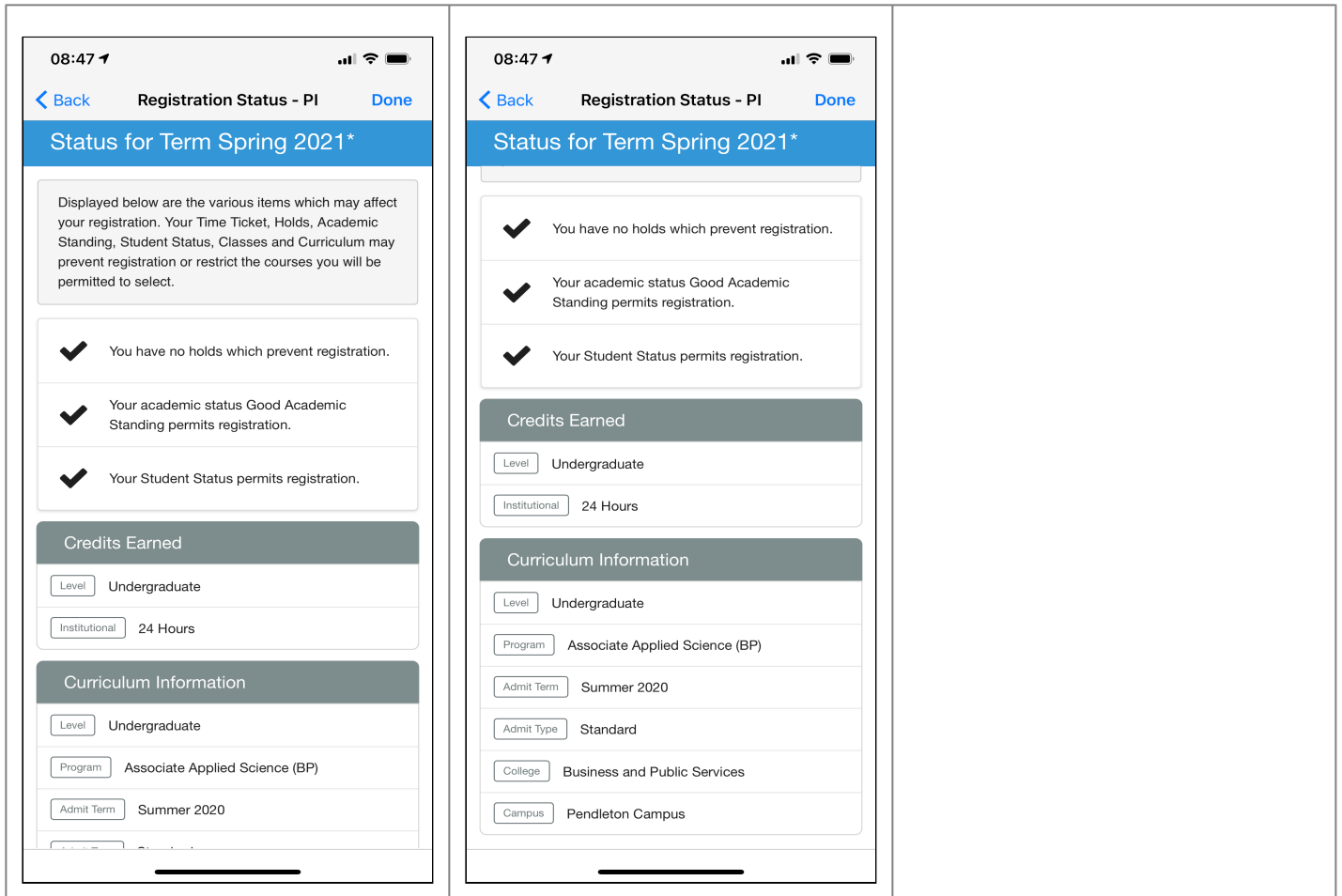

## Technical Overview

The following section describes technical information for the Registration Status product integration.

### Prerequisites

- Access to the client's API.
  - Full advice on allowed lists can be found here - [campusM Allow Lists](#).
  - We recommend making the API public, even if it requires authentication to access.
- User identifier mapping.
  - If you have CMAuth configured, map the relevant vendor ID in the integration profile (Additional Mapping). For example, bannerId=employeeID, where employeeID is the relevant user attribute on the vendor's backend system.
  - If you have LDAP configured, verify that the relevant attribute is returned as an attribute from the LDAP response.
- campusM app test users with a valid vendor ID available through the SAML attributes (via CMAuth login). The ideal types of test users should include:
  - A test user with no restrictions.
  - A test user with one restriction.
  - A test user with multiple restrictions.

- A test user that is not on the vendor's backend system (the vendor ID is typically a generic attribute name like "employeeID" - the user may have this populated, despite not being available through the vendor itself).
- The relevant vendor ID should be mapped in the Integration Profile for the app profile.

---

## Required Format

Select one of the following links for the required format for that vendor:

- Required Format for Ellucian Banner XE (and Banner 9) Vendor
- Required Format for Oracle PeopleSoft Vendor

---

## Ellucian Banner XE (and Banner 9) Vendor

- The Banner version is Banner 9.
- The vendor information for the App Manager instance is as follows:
  - Example URL (to retrieve the information): `https://{HOST}/StudentApi/api`
  - Only the generic endpoint provided above is required.
  - Internally, we use the following API calls, appended to the URL above:
    - `/terms`
    - `/registration-status`
  - API Authentication — the only type of authentication supported is **Basic**, though no authentication is also supported if needed.

Any quotes used above are to separate example values from the documentation - do not use quotes in the Vendor configuration itself, unless they're a part of a value.

---

### Note

- XE is an add-on to Banner that enables customers to extend it.
- For all integrations done prior to this product integration, Banner 9 and XE are interchangeable.
- If you have Banner 9 and the above endpoints enabled, this integration vendor works as expected, unless the output of those API calls have been customized or overridden in some fashion.

---

## Oracle PeopleSoft

Example responses:

Student Terms

GET `https://{host}/PSIGW/RESTListeningConnector/ExecuteQuery.v1/PUBLIC/AAC_CM_STUDENT_TERMS/JSON/NONFILEQuery`

Required parameters, example.:

- `isconnectedquery: N`

- maxrows: 0
- prompt\_uniquepromptname: USER\_ID
- prompt\_fieldvalue: {USER\_ID value}
- json\_resp: true

```
{
  'data':
  {
    'query':
    {
      'numrows': 3,
      'queryname=': 'AAC_CM_STUDENT_TERMS',
      'rows':
      [
        {
          'TERM_CODE': '0261',
          'TERM_DESCRIPTION': '1984 Spring',
          'TERM_ID': '0261',
          'attr:rownumber': 1
        },
        {
          'TERM_CODE': '0263',
          'TERM_DESCRIPTION': '1984 Summer',
          'TERM_ID': '0263',
          'attr:rownumber': 2
        },
        {
          'TERM_CODE': '2190',
          'TERM_DESCRIPTION': '2021 Fall',
          'TERM_ID': '2190',
          'attr:rownumber': 3
        }
      ]
    },
    'status': 'success'
  }
}
```

### Term Info

GET [https://{host}/PSIGW/RESTListeningConnector/ExecuteQuery.v1/PUBLIC/AAC\\_CM\\_REGSTATUS\\_TILE/JSON/NONFILEQuery](https://{host}/PSIGW/RESTListeningConnector/ExecuteQuery.v1/PUBLIC/AAC_CM_REGSTATUS_TILE/JSON/NONFILEQuery)

Required parameters, example.:

- isconnectedquery: N
- maxrows: 0
- prompt\_uniquepromptname: USER\_ID
- prompt\_fieldvalue: {USER\_ID value}
- json\_resp: true

## Basic Authentication (Username and Password)

```
{
  'data':
  {
    'query':
    {
      'numrows': 5,
      'queryname=': 'AAC_CM_REGSTATUS_TILE',
      'rows':
      [
        {
          'ACAD_CAREER': 'GRAD',
          'COURSE_CODE': 'PH-601-01',
          'COURSE_NAME': 'Photography Concept',
          'ENROLLMENT_STATUS': 'Enrolled',
          'PLAN': 'Photography',
          'PROGRAM': 'Master of Arts',
          'STUDENT_ID': '00000575',
          'TERM_CODE': '2130',
          'attr:rownumber': 1
        },
        {
          'ACAD_CAREER': 'GRAD',
          'COURSE_CODE': 'PH-642-01',
          'COURSE_NAME': 'Lighting on Location',
          'ENROLLMENT_STATUS': 'Enrolled',
          'PLAN': 'Photography',
          'PROGRAM': 'Master of Arts',
          'STUDENT_ID': '00000575',
          'TERM_CODE': '2130',
          'attr:rownumber': 2
        },
        {
          'ACAD_CAREER': 'GRAD',
          'COURSE_CODE': 'AAU-101-OL10',
          'COURSE_NAME': 'Launchpad to Online Learning',
          'ENROLLMENT_STATUS': 'Enrolled',
          'PLAN': 'Photography',
          'PROGRAM': 'Master of Arts',
          'STUDENT_ID': '00000575',
          'TERM_CODE': '2130',
          'attr:rownumber': 3
        },
        {
          'ACAD_CAREER': 'GRAD',
          'COURSE_CODE': 'AAU-PH-OL1',
          'COURSE_NAME': 'Launchpad to Online Learning',
          'ENROLLMENT_STATUS': 'Dropped (was enrolled)',
          'PLAN': 'Photography',
          'PROGRAM': 'Master of Arts',

```

```
'STUDENT_ID': '00000575',
'TERM_CODE': '2130',
'attr:rownumber': 4
},
{
'ACAD_CAREER': 'GRAD',
'COURSE_CODE': 'AAU-102-OL6',
'COURSE_NAME': 'Launchpad to Onsite Learning',
'ENROLLMENT_STATUS': 'Enrolled',
'PLAN': 'Photography',
'PROGRAM': 'Master of Arts',
'STUDENT_ID': '00000575',
'TERM_CODE': '2130',
'attr:rownumber': 5
}
]
}
},
'status': 'success'
}
```

---

## Prerequisites

The following prerequisites are required for the Registration Status product integration:

- Access to the client's API.
  - Access is required from DEV DC03, as well as the Jerusalem and Wolverhampton offices.

---

### Note

This is in discussion currently as we do not have a standardized range of IPs available.

---

- We recommend making the API public, even if it requires authentication to access.
- User identifier mapping
  - If you have CMAuth configured, map the relevant vendor ID in the integration profile (Additional Mapping). For example, `bannerId=employeeID`, where `employeeID` is the relevant user attribute on the vendor's backend system.
  - If you have LDAP configured, verify that the relevant attribute is returned as an attribute from the LDAP response.
- campusM app test users with a valid vendor ID available through the SAML attributes (via CMAuth login). The ideal types of test user should include:
  - A test user no restrictions.
  - A test user with one restriction.
  - A test user with multiple restrictions.
  - A test user that is not on the vendor's backend system (the vendor ID is typically a generic attribute name like **employeeID**).

---

**Note**

The user can have this populated, despite not being available through the vendor itself.

---

- The relevant vendor ID must be mapped in the Integration Profile for the app profile.

---

## Configuration

To configure the Registration Status product integration, select **Add Product Integration** from the **Product Integrations** main menu option.

Select **Registration Status** and the following configuration page appears:

The following table describes the configuration options available on this page.

---

**Note**

Non-mandatory fields are displayed with their default values unless otherwise noted.

---

Field Name	Description	Mandatory	Data Type	Default	Example
<b>Manage Integration</b>					
Enable Product Integration	Select to enable the product integration on the user's campusM app.	No	Checkbox	Unchecked	
Product Integration Description	Description for this Registration Status instance. Displayed in App Manager, but not in the app itself.	Yes	String	N/A	Registration Status
Screen Title	Appears in the top header (of the integration, in the app).	No	String	Registration Status	
<b>Vendor</b> – This section defines the structure of the APIs used in this product integration.					
Vendor Name	Defines which vendor the integration connects to.	Yes	Drop-down list	N/A	Colleague
<b>API Configuration for BannerXE</b> This section contains the API details to define the API structure. You can test the API configuration. See <a href="#">Testing API Product Integration Configuration</a> .					
Base URL	Enter the base URL for the vendor API server.	Yes	String	N/A	<a href="https://somehost.comportnumber/">https://somehost.comportnumber/</a> <a href="https://mybannerhost:5555/">https://mybannerhost:5555/</a>

Field Name	Description	Mandatory	Data Type	Default	Example
User Identifier	The parameter input option for ID attribute required for the vendor, for example, the user's Banner ID required for identification in Banner.  Possible values: Username, Token Property, and Constant. It is sent as the path parameter in the relevant API calls.	Yes	Dropdown		
Parameter Input Option	The parameter input option for Banner ID. Possible values: Username, Token Property, and Constant. It is sent as the path parameter.		Yes	Dropdown	Token Property
API Authentication	Authentication type against the web service.	No	Dropdown	No Auth	Basic Auth
<b>Terms Configuration</b> <i>For Banner XE only</i>					
Exclude By Term Code	Enter one or more term codes, or partial codes, to exclude.  Include % in the code for a wildcard sequence, e.g. %5 excludes any term code ending in 5. Entering just 5 excludes any term code that includes a 5 anywhere in it.	No	List		%5
Exclude By Term Description	Enter one or more term descriptions, or partial descriptions, to exclude.  Use % for a wildcard sequence, e.g. %Test excludes any term description ending with	No	List		Non-Academic

Field Name	Description	Mandatory	Data Type	Default	Example
	Test. Entering just <code>Test</code> by itself excludes any term description that includes <code>Term</code> anywhere in it.				
<b>API Configuration - for Oracle PeopleSoft</b>					
Base URL	Enter the base URL for the vendor API server.	Yes	String		<a href="https://someHost.com:portNumber">https://someHost.com:portNumber</a>
URL Query Parameters	Any query parameters required for the PeopleSoft vendor. See <b>Required Format</b> for details.	Yes	List		
URL Path Parameters	Any path parameters required for the PeopleSoft vendor. Currently none.	No	List		
General Headers	Any headers required for the PeopleSoft vendor. Currently none.	No	List		
Authentication Type	Select one of the following options, according to your PeopleSoft server setup: <ul style="list-style-type: none"> <li>• No Auth</li> <li>• Basic Auth</li> <li>• Bearer Token</li> <li>• API Key</li> <li>• OAuth Using User App Authentication</li> <li>• OAuth Using Client Credentials</li> </ul>	No	Drop-down list		Basic Auth
<b>General Configuration</b>					

Field Name	Description	Mandatory	Data Type	Default	Example
Show the Credits Earned section	Enables or disables whether or not the user can see the Credits Earned block.	No	Checkbox	Checked	Show the Credits Earned section
Show the Curriculum Information section	Enables or disables whether or not the user can see the Curriculum Information block.	No	Checkbox	Checked	
Show Holds Information	Enables or disables whether or not the user can see the Holds block.	No	Checkbox	Checked	
Show Course Registration Information	Enables or disables whether or not the user can see the Registration Information block.	No	Checkbox	Unchecked	
Enable Link for More Information	Enables or disables whether or not the user can see the More Information button.	No	Checkbox	Unchecked	
More Information URL	The URL for the More Information button.	No	URI	<a href="https://myDomain.com">https://myDomain.com</a>	
Past Terms (in days)	Display past terms for the last number of days.	No	String	0	
Next Terms (in days)	Display future terms for the next number of days.	No	String	0	
<b>Look and Feel</b>					
Primary Theme Color	Select a color for the main elements on the page.	No	Color Picker	#444444	
Secondary Theme Color	Select a color for the secondary elements on the page.	No	Color Picker	#6f8ea4	
<b>Text/Labels</b>					
Terms Page Header	Displayed at the top of the Terms landing page, if	No	String	Select a Term	

Field Name	Description	Mandatory	Data Type	Default	Example
	enabled.				
No Terms Message	Displayed when the terms service returns a valid response, but there are no valid terms in it.	No	String	No terms found.	
Unknown Terms Text	Displayed any time a term is to be displayed, but there is no valid description for that term.	No	String	Unknown Term	
Registration Status Page Header	Displayed at the top of the selected Registration Status page, followed by the term description.	No	String	Status for Term	
Registration Status Disclaimer	Custom text to outline a student's registration and academic status.	No	String	Displayed below are the various items which may affect your registration. Your Time Ticket, Holds, Academic Standing, Student Status, Classes, and Curriculum may prevent registration or restrict the courses you will be permitted to select.	
No Status Information Message	Displayed when the status service returns a valid response, but there are no valid items in it.	No	String	No status information found for this term.	
Credits Earned Header Text	Shown if "Show the Credits Earned section" is <b>true</b> . This is displayed at the top of the block.	No	String	Credits Earned	
Credits Earned "Level" Label	Shown if "Show the Credits Earned section" is <b>true</b> .	No	String	Level	
Credits Earned "Transfer"	Shown if "Show the Credits Earned section" is <b>true</b> .	No	String	Transfer	

Field Name	Description	Mandatory	Data Type	Default	Example
Hours" Label					
Credits Earned "Institutional Hours" Label	Shown if "Show the Credits Earned section" is <b>true</b> .	No	String	Institutional	
Credits Earned "Hours" Text	Shown if "Show the Credits Earned section" is <b>true</b> . The suffix for displaying any value in hours.	No	String	Hours	
Curriculum Information Header Text	Shown if "Show the Curriculum Information section" is <b>true</b> . This is displayed at the top of the block.	No	String	Curriculum Information	
Curriculum Information "Level" Label	Shown if "Show the Curriculum Information section" is <b>true</b> .	No	String	Level	
Curriculum Information "Program" Label	Shown if "Show the Curriculum Information section" is <b>true</b> .	No	String	Program	
Curriculum Information "Admit Term" Label	Shown if "Show the Curriculum Information section" is <b>true</b> .	No	String	Admit Term	
Curriculum Information "Admit Type" Label	Shown if "Show the Curriculum Information section" is <b>true</b> .	No	String	Admit Type	
Curriculum Information "College" Label	Shown if "Show the Curriculum Information section" is <b>true</b> .	No	String	College	

Field Name	Description	Mandatory	Data Type	Default	Example
Curriculum Information "Campus" Label	Shown if "Show the Curriculum Information section" is <b>true</b> .	No	String	Campus	
Terms Service Failure Message	This message appears when the integration is unable to reach or process the terms API correctly.	No	String	The page is having trouble fetching academic terms - please try again shortly.	
Service Failure Message	This message appears when the integration is unable to reach or process the registration status API correctly.	No	String	The page is having trouble fetching your status - please try again shortly.	
More Information Label	Shown if "Enable Link for More Information" is <b>true</b> .	No	String	Click here for more info	
Course Registration Title Label	Shown if "Show Course Registration Information" is <b>true</b> .	No	String	Course Registration	
<b>Import/ Export Configuration</b>					
You can configure product integration and then export it to another campusM environment, for example, from sandbox to production or from preview to production.					
Export	Create a JSON file with all product integration configuration.	No			
Import	Use this option in order to load configuration from JSON of an exported product integration.	No			